

Getting started with your tablet |

Quick reference sheet

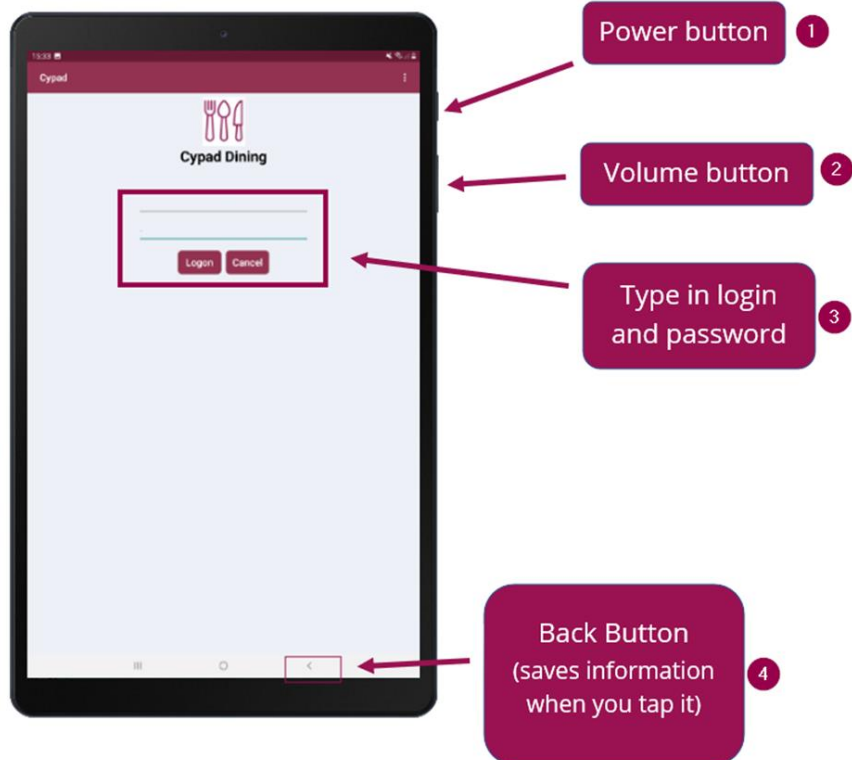

1. Ensure the tablet is stored safely in a dry place and can be easily accessed by anyone that needs to use it.
2. Press and hold the **Power Button [1]** to turn the tablet on/off.
3. Quickly press the **Power Button [1]** to lock the screen.
4. Press the **Volume Button [2]** up/down to adjust the volume.
5. Enter your supplied login details in the **relevant fields [3]**
Note: Passwords are case sensitive.
6. Tap the **Back Button [4]** to return to the previous screen.



Getting started with your tablet | Quick reference sheet



4. Apps will show on the **home screen [1]**.

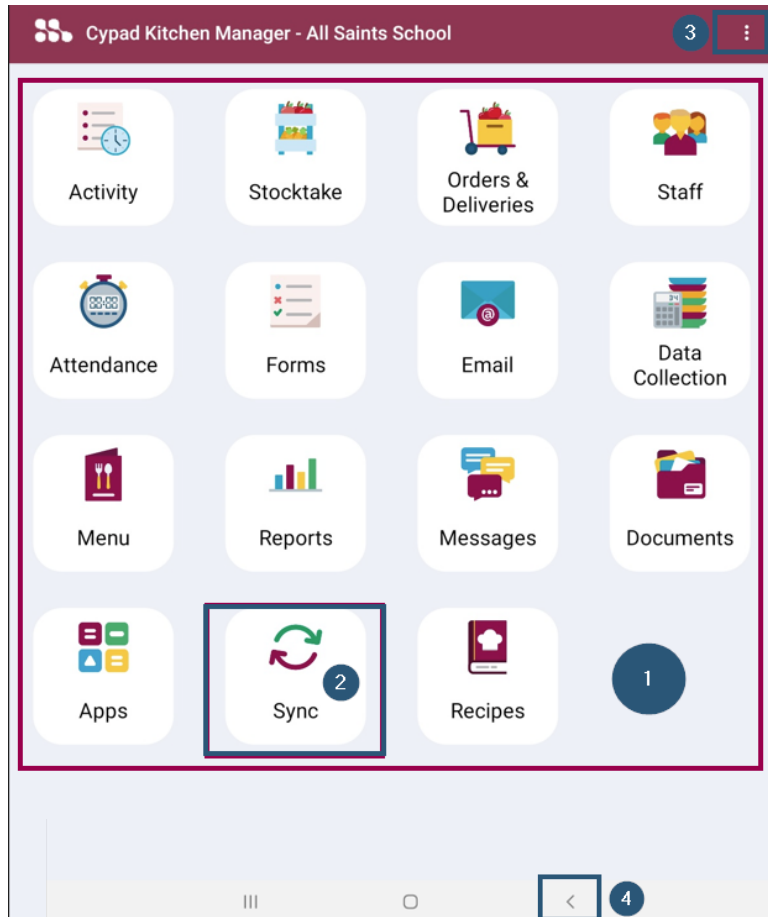

5. Press **Sync [2]** to synchronise the tablet and upload/download any new data.
6. **3 dots (:)** [3] show that extra menu features are available. You will see them mentioned in the instructions later on.
7. Press the **back button [4]** to return to the home screen.
8. Remember to **sync and charge** your tablet at the end of the day.

For further information, please click [here](#) to visit the Cypad support page:

